

N A I S H

ESTATE AGENTS



YORK
EST. 1939



Flat 3, 9 Wenlock Terrace , York, YO10 4DU

A beautiful two-bedroom Victorian apartment located on the historic Wenlock Terrace, Fulford. Sympathetically modernised throughout whilst maintaining period features, this property is ready to move straight into.

£195,000

Flat 3, 9 Wenlock Terrace

, York, YO10 4DU



- Apartment located in a Victorian Building
- Upgraded Kitchen & Shower Room
- Second floor Apartment
- Two Bedrooms
- Spacious Accommodation with Period Features
- Popular Location

Offer Procedure



Directions



Floor Plan

Flat 3, 9 wenlock terrace

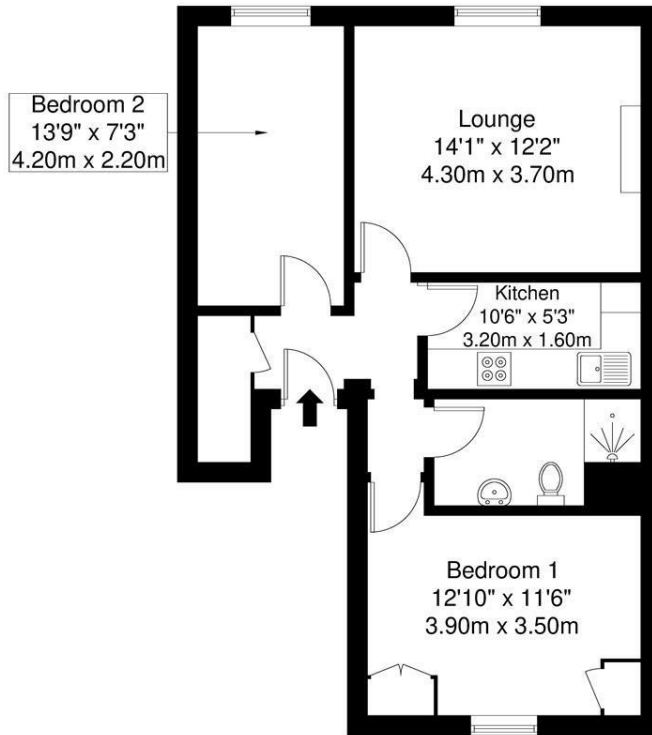

SECOND FLOOR
57.2 sq m / 615 sq ft

APPROXIMATE GROSS INTERNAL AREA = 57.2 sq m / 615 sq ft

Whilst every attempt has been made to ensure the accuracy of the floorplan contained here, measurements of doors, windows, rooms and any other items are approximate and no responsibility is taken for any error, omission or mis-statement. This plan is for illustrative purposes only and should be used as such by any prospective purchaser. The services, systems and appliances shown have not been tested and no guarantee as to their operability or efficiency can be given.

These particulars, whilst believed to be accurate are set out as a general outline only for guidance and do not constitute any part of an offer or contract. Intending purchasers should not rely on them as statements of representation of fact, but must satisfy themselves by inspection or otherwise as to their accuracy. No person in this firm's employment has the authority to make or give any representation or warranty in respect of the property.

3 High Petergate, York, YO1 7EN
Tel: 01904 653564 Email: naish@naishproperty.co.uk www.naishproperty.co.uk

Energy Efficiency Rating		Current	Potential
Very energy efficient - lower running costs			
(92 plus) A			
(81-91) B			
(69-80) C		77	81
(55-68) D			
(39-54) E			
(21-38) F			
(1-20) G			
Not energy efficient - higher running costs			
England & Wales		EU Directive 2002/91/EC	